



Dial Thermometers - TB 100 - Adjustable

- Bi-Metals are made of two different metal sheet layers and a spiral form is given ,as the metals expansion rates differ from each other , due to these factors it spins upwards around its axis by heat.By a transmission wire this movement it is transmitted to the pointer.
 - Used where higher accuracy needed.
 - Used with gas and liquids which do not attack stainless steel 316L.
 - Silicon filled types are used in vibrating environments
- Industry Sector: Petro-chemical plants, Machinery Manufacturing, Heating, ventilation, & conditioning (HVAC) and vessel manufacturers



Usage Properties

Conformity	· EN 13190
Accuracy Class	· CL 2.0
Protection Rate	· IP 65
Storage Temperature	· -40 ... +70 °C

Constructive Properties

Mounting Type	· Bottom Connection · Back Connection
Scale Unit	· °C
Scale Range (T)	· -30/+60°C · 0/+120°C · 0/+160°C · · · 0/+300°C · 0/+350°C · 0/+400°C · 0/+500°C
Case	· Stainless Steel AISI-304
Bezel	· Stainless Steel AISI-304
Window	· Glass
Connection	· G 1/2" B
Dial	· Aluminum
Pointer	· Adjustable Aluminum
Temperature Element	· Bi-metal
Bi-Metal Stem	· Stainless Steel AISI-316
Thermowell	· Stainless Steel AISI-316L
Immersion Length	· 100mm · 150mm · 200mm · 250mm · 300mm · 400mm · 500mm · 700mm · 1000mm
Reading Angle Settable	· Adjustable

Technical Drawings - TB 100 - Adjustable

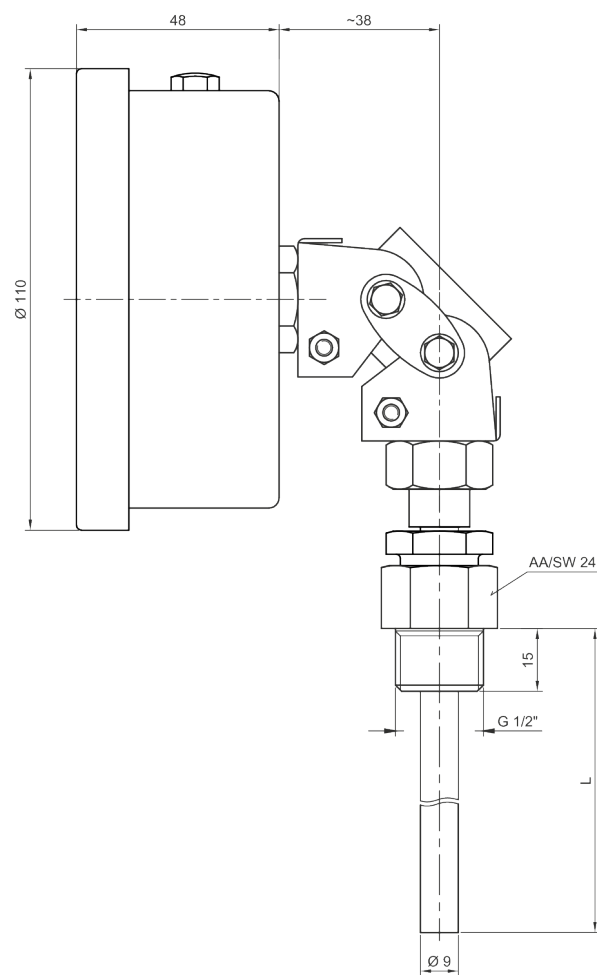

L = 100 L = 150 L = 200 L = 250 L = 300 L = 400 L = 500