

## Dial Thermometers - TB 100

- Bi-Metals are made of two different metal sheet layers and a spiral form is given, as the metals expansion rates differ from each other, due to these factors it spins upwards around its axis by heat. By a transmission wire this movement it is transmitted to the pointer.
- Used with gas and liquids which do not attack stainless steel 316L.

Industry Sector: Petro-chemical plants, Machinery Manufacturing, Heating, ventilation, and conditioning (HVAC) and vessel manufacturers



### Usage Properties

Conformity	· EN 13190
Accuracy Class	· CL 2.0
Protection Rate	· IP 51
Storage Temperature	· -40 ... +70 °C

### Constructive Properties

Mounting Type	· Bottom Connection
Scale Unit	· °C
Scale Range (T)	· 0/+120°C
Case	· Stainless Steel AISI-304
Bezel	· Stainless Steel AISI-304
Window	· Glass
Connection	· G 1/2" B
Dial	· Aluminum
Pointer	· Aluminum
Temperature Element	· Bi-metal
Bi-Metal Stem	· Stainless Steel AISI-316
Thermowell	· Stainless Steel AISI-316L
Immersion Length	· 100mm

## Technical Drawings - TB 100

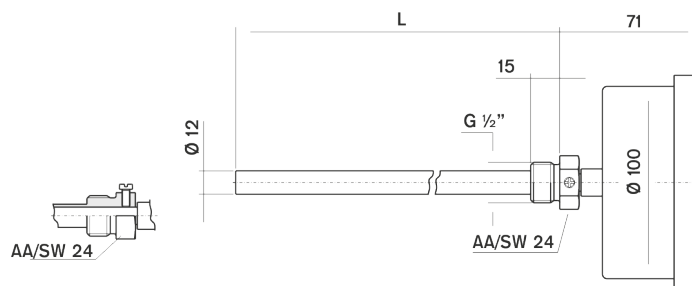
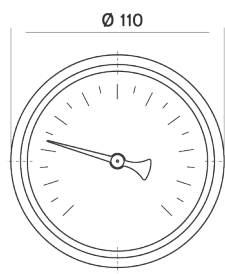

L = 100

L = 150

L = 200

L = 250

L = 300

L = 400

L = 500

L = 700

L = 1000

100 412 /

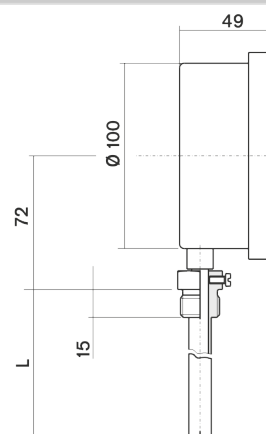
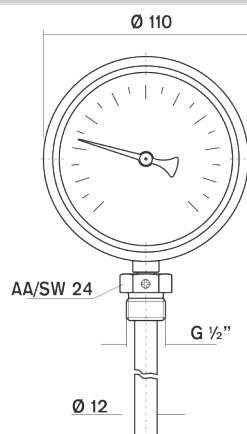

L = 100

L = 150

L = 200

L = 250

L = 300

L = 400

L = 500

L = 700

L = 1000

100 411 /