

Radiator Valves - Standard Radiator Valves

- Connected to inlet and outlet of radiators in heating systems to adjust flow of fluid manually. You can close off the circulation of fluid by these valves and service your radiators when needed.
- Suitable to use with Panel, Aluminum Panel and Cast Iron Radiators in central heating systems.

Usage Properties

Conformity	· TS 579
Fluid Temperature	· Maximum + 120 °C
Storage Temperature	· -20 ... +60 °C
Max.Pressure	· PN 10

Constructive Properties

Case	· Brass - Nickel Plated
Connection	· G 1/2" B
Nominal Diameter	· DN 15
Radiator Connection	· G 1/2" B
Sealing	· Brass
Knob	· Plastic

Technical Drawings - Standard Radiator Valves

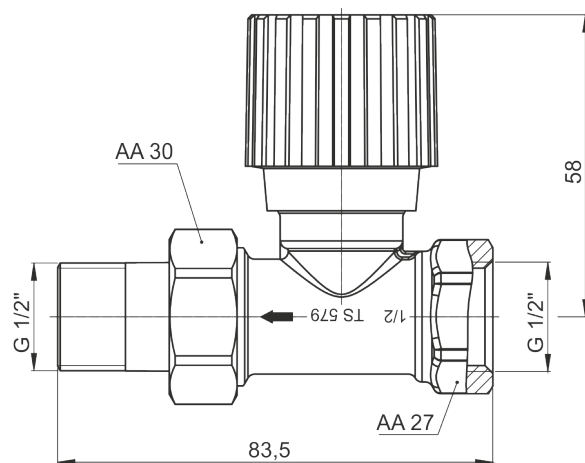

096821 /

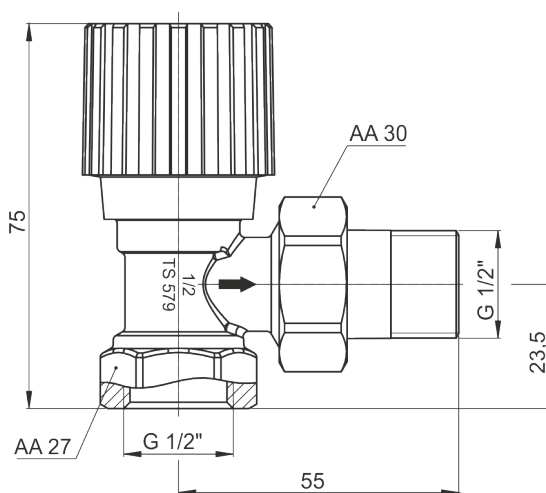

096811 /