

## Hydraulic Groups - HB-119

Fully brass hydraulic group with side pump connection, designed for combi type heating devices.

Compatible with all circulation pump make and models (can be used with pumps that have lower than standard pump inlet to bracket distance), and suitable to be used with off and stepper type 3WV actuators.

Standard content of delivery includes flow and return blocks with DHW filter, flow regulator as per customer request, radial type turbine flow meter with Hall effect sensor, manual filling tap, 3WV cartridge, ½" and ¾" brass connection nipples.

The hydraulic set could be customized and provided with a plate heat exchanger, 3WV motor, pressure switch or sensor and NTC sensor upon customer request.

### Constructive Properties

Flow Detection	· Turbine Type Flowmeter with Hall Effect Sensor
Pump Connection	· Side
By-Pass Type	· Through PHE
Material	· CuZn40Pb2 (CW617N)
Flow Regulator	· 6 to 22 (lt/min)
Pressure Relief Valve	· 3 bar ½"

# Technical Drawings - HB-119

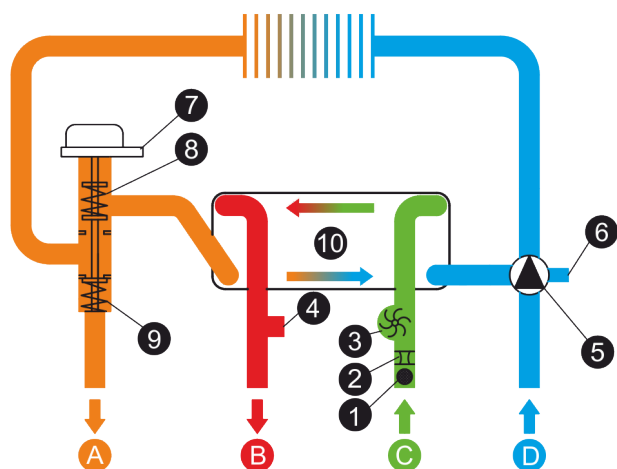

/

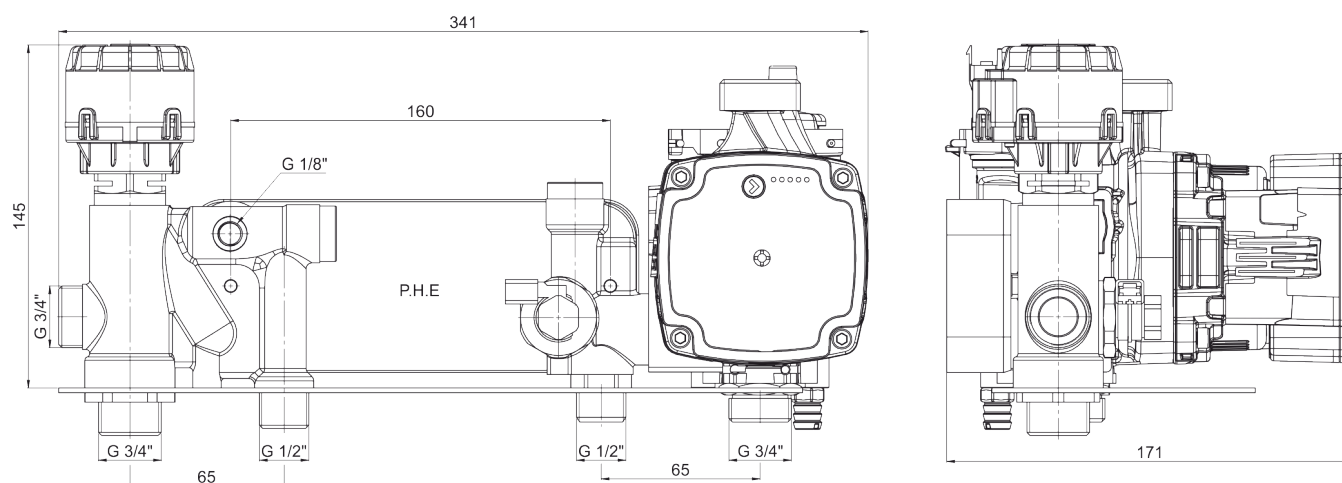

/